

Prinsu

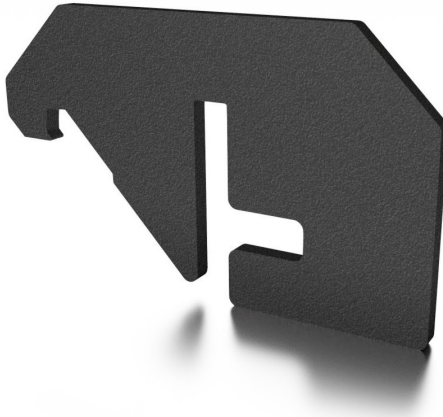

# BOTTLE OPENER



## **Applications**

installation instructions

These installation instructions apply all Prinsu roof and top racks

## **IMPORTANT!**

**THANK YOU** for purchasing this Prinsu product. Please read through this entire document before proceeding with installation. If you are not confident in your mechanical skills, please seek the help of a professional to perform the installation. Check your packages immediately upon arrival to ensure that everything listed is included, and to check for damage during shipping. ***If anything is missing or damaged, or if you need technical assistance with any aspect of this installation, call Prinsu at (208) 528-0664 as soon as possible.***

**IMPORTANT!**

**Caution:**

The handling characteristics of the vehicle changes when you transport a load on top of the vehicle. For safety reasons we recommend you exercise extreme care when transporting wind-resistant loads. Special consideration must be taken into account when cornering and braking.

**Note for Dealers and Installers:**

It is your responsibility to ensure instructions are given to the end user or client.

**Hardware 1:1 Scale View**

**A** 1 – 1/4"-20x3/4" Carriage bolt

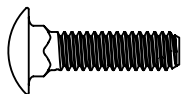

**B** 1 – 1/4" Flat Washer



**C** 1 – 1/4" Nylock Nut

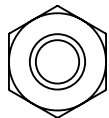

**Exploded Product/Hardware View**

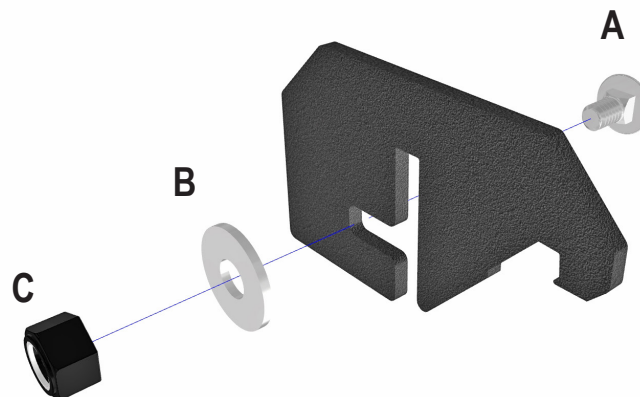

**Questions?**

Call: 866-522-0697

Email: [info@prinsudesign.com](mailto:info@prinsudesign.com)



792 E Iona Rd.  
Idaho Falls, ID 83274  
[prinsudesignstudio.com](http://prinsudesignstudio.com)  
**208.528.0664**