

2022 Sequoia

COVERT BUMPER



Applications

installation instructions

These installation instructions apply to the following CBI Off Road products

– **Sequoia** Bed Bars | 2022-Present

IMPORTANT!

THANK YOU for purchasing this CBI product. Please read through this entire document before proceeding with installation. If you are not confident in your mechanical skills, please seek the help of a professional to perform the installation. Check your packages immediately upon arrival to ensure that everything listed is included, and to check for damage during shipping. ***If anything is missing or damaged, or if you need technical assistance with any aspect of this installation, call CBI at (208) 528-0664 as soon as possible.***

IMPORTANT!

If your CBI product comes as unpainted, bare steel or aluminum. You will want to either powder coat or paint prior to final installation, however it is very important to PRE-INSTALL the unpainted product first, following these instructions, BEFORE painting or powder coating any of the components! This will ensure that all parts are correct and any incidental trimming or drilling will have been done prior to coating. Also, it will give you a practice run to familiarize yourself with the process, to lessen the likelihood of damaging the finish during final installation.

CBI Off Road is NOT RESPONSIBLE for paint or powder coating costs, damage to paint or powder coating, or costs associated with inadvertently painting or powder coating components that are defective or were shipped or assembled in error. It is the customer's responsibility to pre-install and verify that all parts are correct prior to paint or powder coat

Note for Dealers and Installers: It is your responsibility to ensure instructions are given to the end user or client.

Hardware

| Sequoia Covert Bumper Hardware | |
|---|-----|
| DESCRIPTION | QTY |
| 1/2"-13 x 1-1/2" Steel Hex Cap Screw Yellow Zinc | 4 |
| 1/2"-13 x 4-1/2" Grade 8 Yellow Zinc Finish Hex Cap Screw | 2 |
| 3/8"-16 x 1-1/2" Steel Hex Cap Screw Zinc | 4 |
| 1/2"-13 Steel Nylon Insert Flange Nut Zinc | 6 |
| 3/8"-16 Steel Nylon Insert Flange Nut Zinc | 4 |
| 1/2" x 1-3/8" Steel Flat Washer | 8 |
| 3/8" x 13/16" Steel Flat Washer | 6 |
| M12 x 30mm OD DIN 7349 Low Carbon Zinc Finish Steel Extra Thick General Purpose Flat Washer | 2 |
| 1/4"-20 x 3/4" Steel Carriage Bolt Zinc | 4 |
| 1/4"-20 Stainless Steel Hex Nylon Insert Lock Nut Plain | 6 |
| 1/4"-20 x 3/4" Steel Hex Cap Screw Zinc | 2 |
| 1/4" x 5/8" Stainless Steel Flat Washer | 8 |
| 1/2" x 1-1/16" Steel Flat Washer | 2 |
| Vibra-Tite 111 Low Strength Threadlocker | 1 |
| M6-1.0 x 16mm DIN 603 Class 8.8 Zinc Finish Steel Carriage Bolt | 4 |
| M6x1 Zinc Plated Class 8 DIN 6926 Hex Flange Nut w/ Nylon Insert | 4 |
| 3/8"-16 x 3/4" Stainless Steel Button Head Socket Cap Plain | 2 |
| 3/8"-16 Stainless Steel Flange Nut Plain | 2 |
| 1/2"-13 x 1" ASTM F879 Hex Drive 18-8 Stainless Steel Button Socket Cap Screw | 8 |

Brackets

Thick Shims

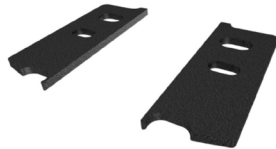

Thin Shims



Grill Support



Tools Required

10mm Wrench or Socket
 Flat head Screwdriver
 17mm Wrench or Socket
 Metal Cut off Wheel
 Metal Sanding Disc
 Scissors or razor knife
 Side Cutting pliers
 3/4 Wrench or Socket
 9/16 Wrench or Socket
 7/16 Wrench or Socket
 Deburr Tool
 Electrical Tape
 3/8" Allen

1. Removing the Grill

Remove 10mm head bolts on the front side of the wheel well on both sides of the vehicle.

Remove the 10mm bolts on the underside of the bumper (4).

Remove the 10mm bolts on the top side of the grill (4).

Using a flat head screwdriver remove the two plastic clips on the top side of the grill.

Unplug sensors on the top side of the grill if applicable.

Pull outward on the fender flare to release it from the bumper

Pull outward on the bumper where the fender flare was previously to release it from the vehicle. Be careful with this step, have a buddy hang onto the grill so that it doesn't come crashing down! Be brave pulling the sides outward, it takes a fair amount of force to unclip the bumper from the vehicle. Once the bumper is unclipped remove it and set it aside, be careful not scratch it!

2. Removing Factory Parts

If your vehicle has an electric air dam you will need to unplug the electrical connector so that it can be removed.

If you don't want a notification on your dash once the air dam is removed check out CBI's Air dam Delete Module! If applicable the air dam motor will be bolted to the aluminum crash bar.

Using a 17mm wrench or socket, remove the crash bar bolts (8) and discard the crash bar.

Using a 12mm Remove the factory skid bolts (4)

Remove the plastic caps that are in the frame just below the intercoolers. There are two caps on each side of the frame. A flat head screwdriver works well.

3. Installing the Winch Tray

You have the option to use the included winch tray shims if the winch tray sits too close to the grill. The shims install between the winch tray and the bottom of the frame. We recommend starting without the shims and check spacing at the end of the install.

With the help of a friend, hold the winch tray into place between the frame rails, and install the 1/2"x4" bolts through the frame and the winch tray (2) leave hand tight for now.

Now using electrical tape, tape a 1/2" nut onto a 3/4" wrench. Starting with the furthest hole on the bottom of the winch tray, insert a 1/2" bolt and your wrench with the nut taped on. Now you can thread the bolt into the taped nut.

Next up is the center hole under the winch tray, this will be a 3/8" nut taped to a 9/16" wrench. Insert the 3/8" bolt and thread it into your taped 3/8" nut.

Last hole will be a 1/2" bolt that you can easily reach to thread the 1/2" nut on.

Repeat on the other side.

Once all the bolts have been started, tighten everything down. Including your long 1/2"x4" bolt.

Remove the black lower grill support, and replace it with the included CBI brackets. (4 10mm head bolts). Re-mount the factory horizontal section of the grill support onto the CBI brackets in the same fashion that it was from the factory (6 10mm nuts).

At this point if you have a winch to install, now's the time!

Depending on the winch size you may need to relocate the rubber coolant hoses up higher to accommodate the winch. Be careful not to have any sharp bends in the hoses, or have direct contact with any sharp edges.

Typically with most winches you are able to leave the solenoid on the winch.

4. Installing the bumper face

Slide the bumper face over the winch tray and start factory bolt into the bottom hole securing the bumper face to the frame. Leave loose.

Insert spacer (thickest washer provided in your kit) between the bumper face and the frame on the top hole and insert $\frac{3}{8}$ " bolt through the bumper face, spacer, and top hole on the frame and thread a nut on.

Repeat on the other side.

Make sure your winch line is properly routed through the bumper face.

Install winch fairlead if applicable.

Tighten down bumper face hardware.

The bumper face has two holes on the top designed for mounting a light bar. You are able to fit a single row 20" Light Bar. Now is the time to mount it if you got it!

5. The moment we've all been waiting for! Cutting the grill!

Ok take a break, grab some water. Don't rush these steps. Remember, every time you walk by your Sequoia you will think back to this moment and be glad you took your time to do a great job!

With the grill face down pop out the two inner parking sensors and the plastic piece they are secured to, so we don't damage them during the cutting process.

Also take a flat head screwdriver and pop out the wire harnesses that run along the bottom of the grill to avoid damage.

Cut the plastic tabs joining the bottom plastic cap (that we are replacing with an awesome CBI Covert bumper) to the bottom of the grill and bumper.

Pop the bottom plastic piece out.

The plastic piece that holds the parking sensors in will be reused, everything below that will be replaced with the Covert bumper.

Sand the remainder of the bottom plastic piece until you are flush with the painted bumper surface, use a deburr tool or razor blade to clean up the plastic edges.

Clip the wire harnesses back into place.

6. Reinstall the grill.

Now slide the grill into place, it's a good idea to have a friend help you due to the colossal size of the grill assembly.

Get the sides clipped back in first, then reinstall the 10mm head bolts on top, clips on top, and 10mm bolts in the fender flare.

You will now be able to trim to fit the plastic piece that holds the parking sensors.

Don't forget to plug all of your factory wiring harnesses back in.

If the bumper is sitting too close to the plastic bumper, you can install one of the shims between the winch tray and the frame, unfortunately you would have to remove the grill again and remove the bumper face. But again a small price to pay for perfection every time you look at your Sequoia!

If you are installing a Bull Bar, now is the time **MAKE SURE TO USE ANTI SEIZE ON THE BULL BAR BOLTS!! THREAD BOLTS BY HAND AND SNUG THEM TIGHT WITH A RATCHET OR SINGLE ALLEN TOOL, NO IMPACTS!** If you cross thread these bolts you will hate your life...If you strip the head of these bolts out you will hate your life... Hope this clears it up!
Good Job, way to hang with us until the end!



792 E Iona Rd.
Idaho Falls, ID 83274
cbioffroadfab.com
208.528.0664