

**DRIVER SIDE**

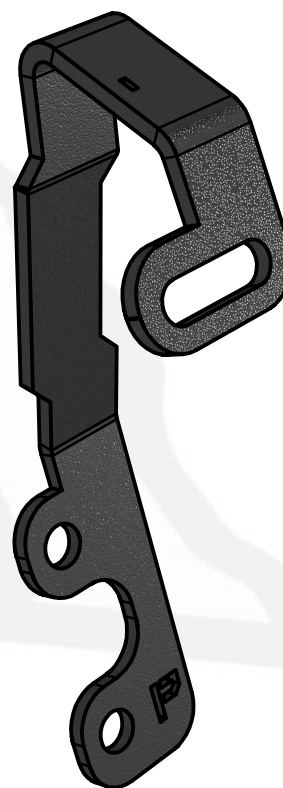

**PASSENGER SIDE**

**REQUIRED TOOLS:**

(NOT INCLUDED)

- **12MM WRENCH OR SOCKET**

NOTE: Suggested tools are not comprehensive, and may require case-by case or discretionary substitutions.

Where power tools are used: use care not to over-tighten fasteners. -ALWAYS wear safety glasses-

Hardware quantities are shown as product design requires. In some cases, additional quantities are sent to act as a buffer for lost or damaged hardware during installation. Hardware/fastener finish, style, and exact color may vary due to many variables, such as current availability and varying manufacturer sourcing.

## DITCH LIGHT BRACKETS



Designed and Manufactured by:  
CBI OFF-ROAD FABRICATION  
3180 N. Wright Road, Idaho Falls ID 83401

### INSTALLATION INSTRUCTIONS

MAKE:	MODEL:	GEN:	TRIM:	CONFIGURATION:
TOYOTA	TUNDRA	3rd	ALL	ALL

**NOTE:** This document should be used in conjunction with, and is supplementary to, the associated install video for that given product. [▶ CBI Install: 2022 Tundra DLB](#)

## **A. PREPARATION**-----

- 1. Gather parts, and necessary tools.**
- 2. Visually check included components for any obvious defects. Such as manufacturing defects, or damage obtained during shipping.**

## **B. INSTALLATION**-----

- 1. Raise Hood by locating the interior hood switch inside the cab of the vehicle, and disengaging the latch under the hood.**
- 2. Starting on either side of the vehicle locate the 2 hood mounting bolts. To prevent alignment shift of the hood, loosen and remove the top mounting bolt ONLY.**
- 3. Place the associated CBI mounting bracket (passenger/driver) in proper orientation and alignment to the bolt hole and vehicle. Replace and tighten mounting bolt through CBI Mounting Bracket. Tighten bracket as much as possible while maintaining slight rotational adjustability.**
- 4. Loosen and remove second, lower, mounting bolt; then rotate bracket into alignment with second hole. Replace and tighten mounting screw.**
- 5. Repeat steps 2-3 on the opposite side of vehicle.**

**THANK YOU** for purchasing this CBI OFF-ROAD FABRICATION product. Please read through this entire document before proceeding with installation. All products built and designed by CBI OFF-ROAD FABRICATION are intended for off-road use and should be assembled, installed, and used according to CBI OFF-ROAD FABRICATION's recommendations. CBI OFF-ROAD FABRICATION products should be used safely with good judgment towards others and the environment. By installing CBI OFF-ROAD FABRICATION Products on your vehicle you assume all liability. CBI OFF-ROAD FABRICATION will not be held liable for damages or loss associated with the installation or use of its products. Be smart, use good judgment, don't overload your vehicle to the point of inferior handling and maneuverability! The handling characteristics of the vehicle changes when body modifications are made. For safety reasons we recommend you exercise extreme care when transporting wind-resistant loads. Special consideration must be taken into account when cornering and braking. If you are not confident in your mechanical skills, please seek the help of a professional to perform the installation. Check your packages immediately upon arrival to ensure that everything listed is included, and to check for damage during shipping. If anything is missing or damaged, or if you need technical assistance with any aspect of this installation, call CBI OFF-ROAD FABRICATION at (208) 528-0664 as soon as possible.

CBI OFF-ROAD FABRICATION will warranty all CBI OFF-ROAD FABRICATION manufactured parts for a LIFETIME of use. This limited Lifetime Warranty is effective for as long as the original retail purchaser owns the product. This warranty terminates when the original retail purchaser sells or otherwise transfers the product to any other person. Each manufactured product must be installed following CBI OFF-ROAD FABRICATION'S recommended fitment and installation procedures. Any customization or modification to the original product design, functionality, or use, either by said customer or by CBI OFF-ROAD FABRICATION voids all warranty eligibility. It is the sole discretion of CBI OFF-ROAD FABRICATION to determine warranty eligibility. Subject to the limitations and exclusions described in this warranty, CBI OFF-ROAD FABRICATION will remedy defects in materials or workmanship by repairing or replacing, at its option, a defective product without charge for parts. In addition, CBI OFF-ROAD FABRICATION may elect, at its option, not to repair or replace a defective product but rather issue to a purchaser a refund equal to the purchase price paid for the product or a credit to be used toward the purchase of a new CBI OFF-ROAD FABRICATION product. No warranty is given for defects caused by normal wear and tear, cosmetic rust scratches, accidents, unlawful vehicle operation, products used for racing or competition, or modification of, or any types of repair of, a CBI OFF-ROAD FABRICATION manufactured product. The CBI OFF-ROAD FABRICATION Warranty does not include the powder coated finish. No warranty is given for defects resulting from conditions beyond CBI OFF-ROAD FABRICATION'S control including, but not limited to, misuse, neglect, overloading, improperly maintained or failure to assemble, mount or use the product in accordance with CBI OFF-ROAD FABRICATION'S written instructions or guidelines included with the product or implied use made available to the purchaser. Disclaimer of liability repair or replacement of a defective product or the issuance of a refund or credit (as determined by CBI OFF-ROAD FABRICATION) is a purchaser's exclusive remedy under this warranty. Damage to a purchaser's vehicle, cargo and/or to any other person or property is excluded. This warranty is expressly made in lieu of any and all other warranties, express or implied, including the warranties of merchantability and fitness for a particular purpose. CBI OFF-ROAD FABRICATION's sole liability to any purchaser is limited to the remedy set forth above. In no event will CBI OFF-ROAD FABRICATION be liable for any lost profits, lost sales, or for any consequential, direct, indirect, incidental, special, exemplary, or punitive damages or for any other damages of any kind or nature.